



# COOK



## 165V7B-26

### Exhaust Ventilator Roof or Wall Mounted/Belt Drive

#### STANDARD CONSTRUCTION FEATURES:

All aluminum housing - Backward inclined all aluminum wheel - Two piece top cap with stainless steel quick release latches - One piece bottom spinning - Welded curb cap corners - Lifting Lugs - Permanently lubricated ball bearing motors - Oil and heat resistant, static conducting belts - Adjustable pitch drives through 5 hp motor - Corrosion resistant fasteners - Regreasable bearings in cast iron pillow block housing, rated at 200,000 hours average life - All fans factory adjusted to specified fan RPM - Transit tested packaging.

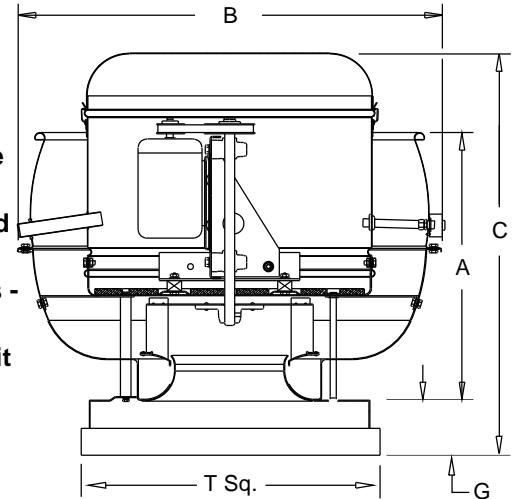

#### Performance (\*Bhp includes 10% drive loss)

Qty	Catalog Number	Flow (CFM)	SP (inwc)	Fan RPM	Power* (HP)
1	165VCR	3302	.500	1325	.870

Altitude (ft): 0 Temperature (F): 70

#### Motor Information

HP	RPM	Volts/Ph/Hz	Enclosure	Mounted
1	1725	115/1/60	ODP -SE	Yes

#### Sound Data Inlet Sound Power by Octave Band

1	2	3	4	5	6	7	8	LwA	dBA	Sones
85	91	89	78	73	72	66	60	84	72	22

#### Accessories:

UL762 (327Y-300DEG)

#### Dimensions (inches)

A	20-15/16
B	34-11/16
C	32-3/4
G	4
T Sq.	26
Roof Open. Sq.*	19-1/2

NOTE: Accessories may affect dimensions shown.

Shipping Weight(lbs)***	127
-------------------------	-----

\*\*\*Includes fan, motor & accessories.

