

**AIR CLEANER DATA:**

CABINET 16 GA STEEL WELDED  
 VOLTAGE/PH/HZ 230/1/60  
 POWER RATING 250 WATTS

**MISCELLANEOUS DATA:**

PCU STATIC FOR 4,000 CFM: 2" WG  
 MIN WATER PRESSURE: 25 PSI  
 RECOMMENDED WATER PRESSURE:  
 MAX WATER PRESSURE: 40 PSI  
 REGULATE IF NECESSARY 50 PSI  
 RECOMMENDED WASH WATER TEMPERATURE:  
 125-160 °F

**FILTER & COMPONENTS SCHEDULE:**

- |  |                    |
|--|--------------------|
| 1. ALUMINUM MESH PREFILTER                             | 24"X24"X1" (2)     |
| 2. ELECTRONIC CELL                                     | 24"X24"X10.75" (2) |
| 3. ALUMINUM MESH POSTFILTER                            | 24"X24"X1" (2)     |
| 4. MERV-14 ASHRAE 52.2 PLEATED PREFILTER               | 24"X24"X4" (2)     |
| 5. ODOR NEUTRALIZER: SIXTEEN 2" TRAYS OF 288 LBS TOTAL |                    |

**NOTES:**

- ALL DIMENSIONS ARE NOMINAL AND GIVEN IN INCHES
- FAN, FAN CONTROL, FAN TRANSITION, BY OTHERS
- ANSUL SYSTEM, DETERGENT TANK, AND RECOMMENDED DRIP-TRAY PROVIDED BY OTHERS
- WATER AND POWER CONNECTIONS BY OTHERS PER LOCAL CODE

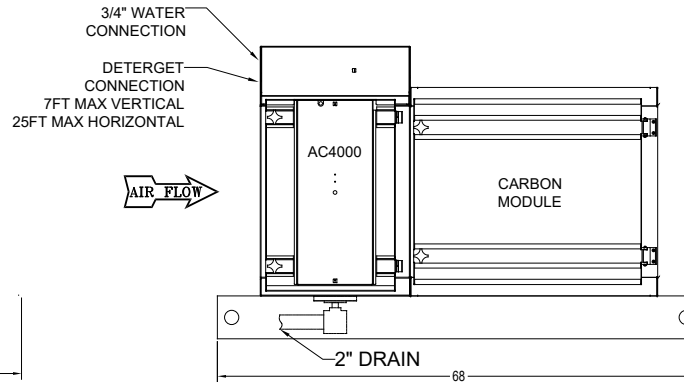
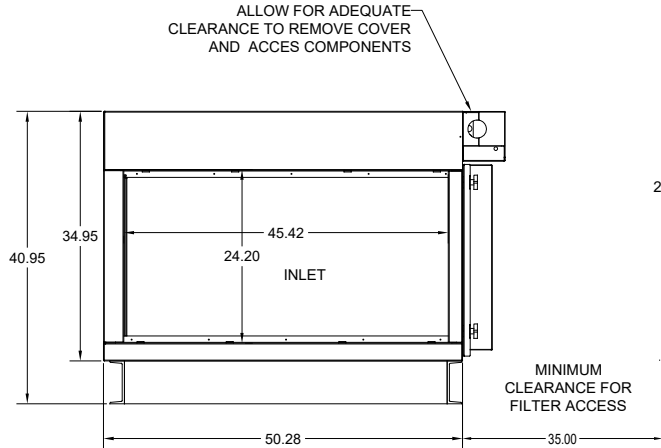
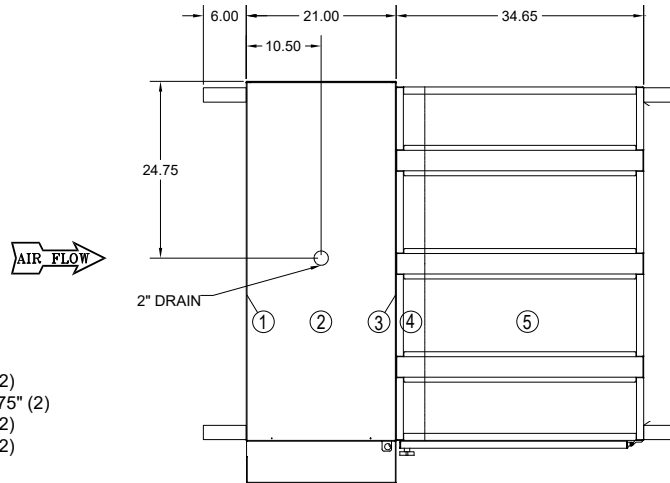

Date: \_\_\_\_\_  
 Approved by: \_\_\_\_\_

Air Quality Engineering  
 Phone (888) 883-3273  
 Fax (763) 531-9900  
 www. Air-Quality-Eng.com